

**PPE (PERSONAL PROTECTIVE EQUIPMENT)  
GUIDELINES FOR QMRS TEAM MEMBERS**

These guidelines provide advice about using personal protective equipment (PPE) to minimise exposure to risks associated with being an active team member in the Queensland Mines Rescue Service Ltd (QMRS).

As per Standard Operating Procedures used on your minesite, the current requirements for QMRS operations are the same, and should be followed to the letter. Failure to wear PPE while responding to incidents, training or competing will result in the team member being excused. Safety signs are positioned around the station for your protection, so please observe the signs.

**Under no circumstances are open shoes (i.e. thongs) to be worn in or around the station, even after utilising the bathhouse showers.**

**QUEENSLAND MINES RESCUE SERVICE  
TRAINING AREA FLOOR PLAN**

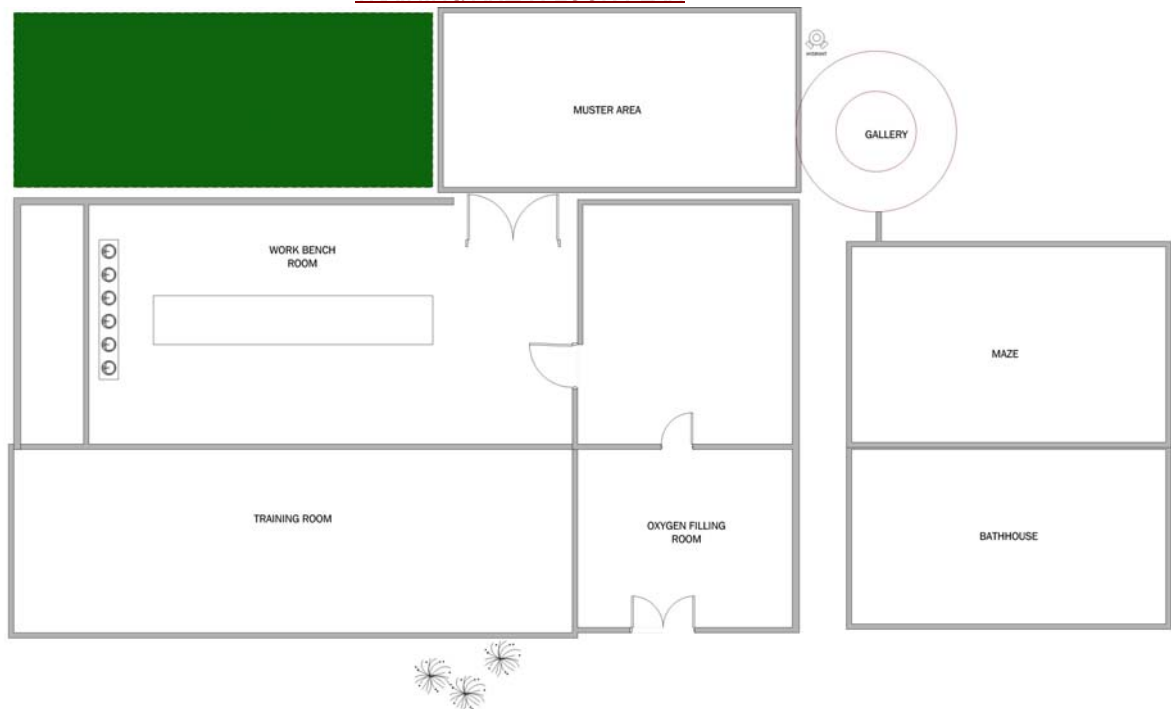

GARNHAM DRIVE



The following table lists PPE requirements for the QMRS.

LOCATION	CONDITIONS	PPE REQUIREMENTS
<b>OXYGEN FILLING ROOM</b> SEE MAP	FILLING AND DECANTING	<ul style="list-style-type: none"> <li>• HEARING PROTECTION</li> <li>• EYE PROTECTION</li> <li>• OBSERVE SAFETY SIGNS</li> </ul>
	FLOORS	<ul style="list-style-type: none"> <li>• COVERED FOOTWEAR</li> <li>• WORK SHIRTS</li> <li>• LONG WORK PANTS OR OVERALLS</li> <li>• OBSERVE SAFETY SIGNS</li> </ul>
<b>WORK BENCH ROOM</b> SEE MAP	FLOORS	<ul style="list-style-type: none"> <li>• COVERED FOOTWEAR</li> <li>• WORK SHIRTS</li> <li>• LONG WORK PANTS OR OVERALLS</li> <li>• OBSERVE SAFETY SIGNS</li> </ul>
	DRYING PARTS	<ul style="list-style-type: none"> <li>• HEARING PROTECTION</li> <li>• EYE PROTECTION</li> <li>• OBSERVE SAFETY SIGNS</li> </ul>
<b>GALLERY</b> SEE MAP	HOT AND HUMID CONDITIONS POOR VISIBILITY CONFINED SPACES	<ul style="list-style-type: none"> <li>• OVERALLS OR</li> <li>• LONG SLEEVED SHIRT AND LONG PANTS (COTTON DRILL NOT NYLON)</li> <li>• COVERED FOOTWEAR</li> <li>• SAFETY HELMET</li> <li>• GLOVES</li> <li>• OBSERVE SAFETY SIGNS</li> </ul>
<b>GAG SHED</b> SEE MAP	WHOLE SHED FORKLIFT JET FUEL	<ul style="list-style-type: none"> <li>• COVERED FOOTWEAR</li> <li>• WORK SHIRTS</li> <li>• LONG WORK PANTS OR OVERALLS</li> <li>• OBSERVE SAFETY SIGNS</li> </ul>
<b>MINESITE TRAINING</b>	AS PER MINE SOPS	<ul style="list-style-type: none"> <li>• COVERED FOOTWEAR</li> <li>• WORK SHIRTS</li> <li>• LONG WORK PANTS OR OVERALLS</li> <li>• SAFETY HELMET</li> <li>• OBSERVE SAFETY SIGNS</li> </ul>